

BRACING N3

Upper Level

DIRECTION	AREA	PRESSURE	REQUIRED	ACHIEVED
↕	22.4m ²	1.4	31.4 kN	37.8 kN
↔	18.2m ²	1.4	25.5 kN	32.4 kN

A= 6kN/m plywood bracing as per AS1684.2-2006 Table 8.18 'h'.

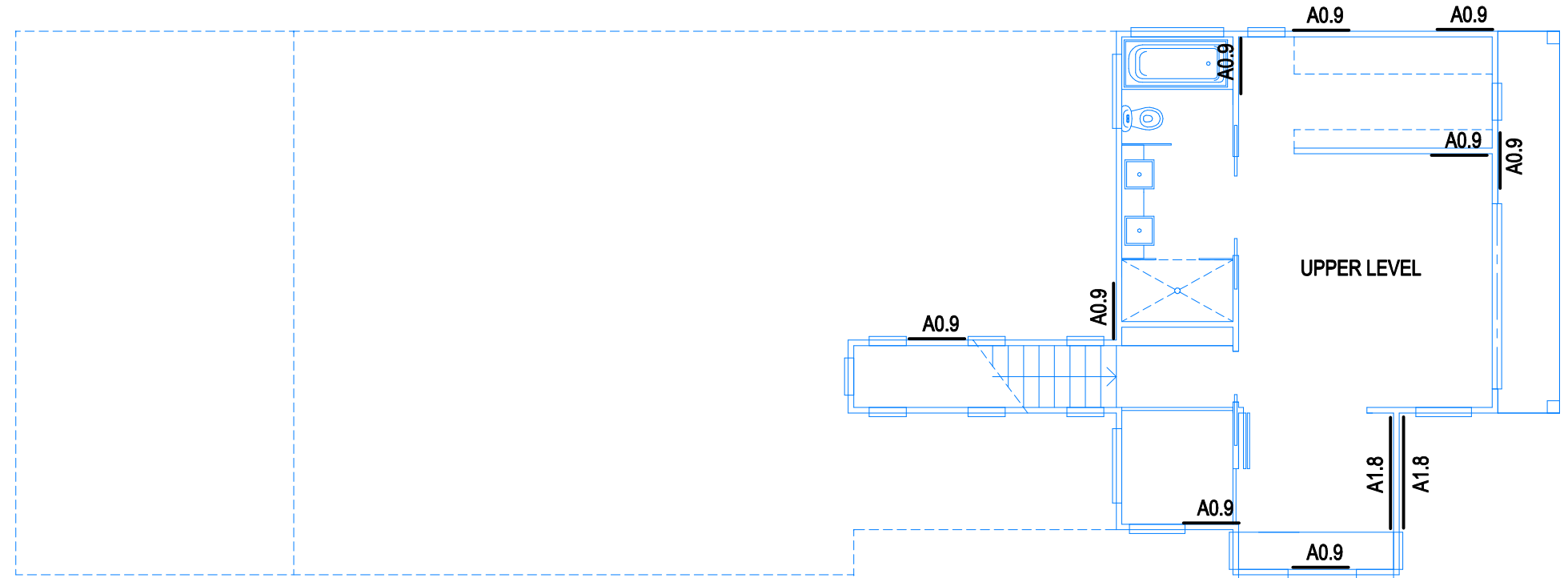

PT BRACE LOAD TABLE		
WIDTH	DEPTH	ULTIMATE LOAD
350mm	62mm	6.5kN
450mm	62mm	11.3kN
600mm	62mm	16.9kN

Ground

DIRECTION	AREA	PRESSURE	REQUIRED	ACHIEVED
↕	55.9m ²	1.4	78.3 kN	54 kN
↔	20.2m ²	1.4	28.3 kN	32.4 kN

A= 6kN/m plywood bracing as per AS1684.2-2006 Table 8.18 'h'.

Bracing capacity of blockwork not included in calculations - engineer to confirm achieved capacity

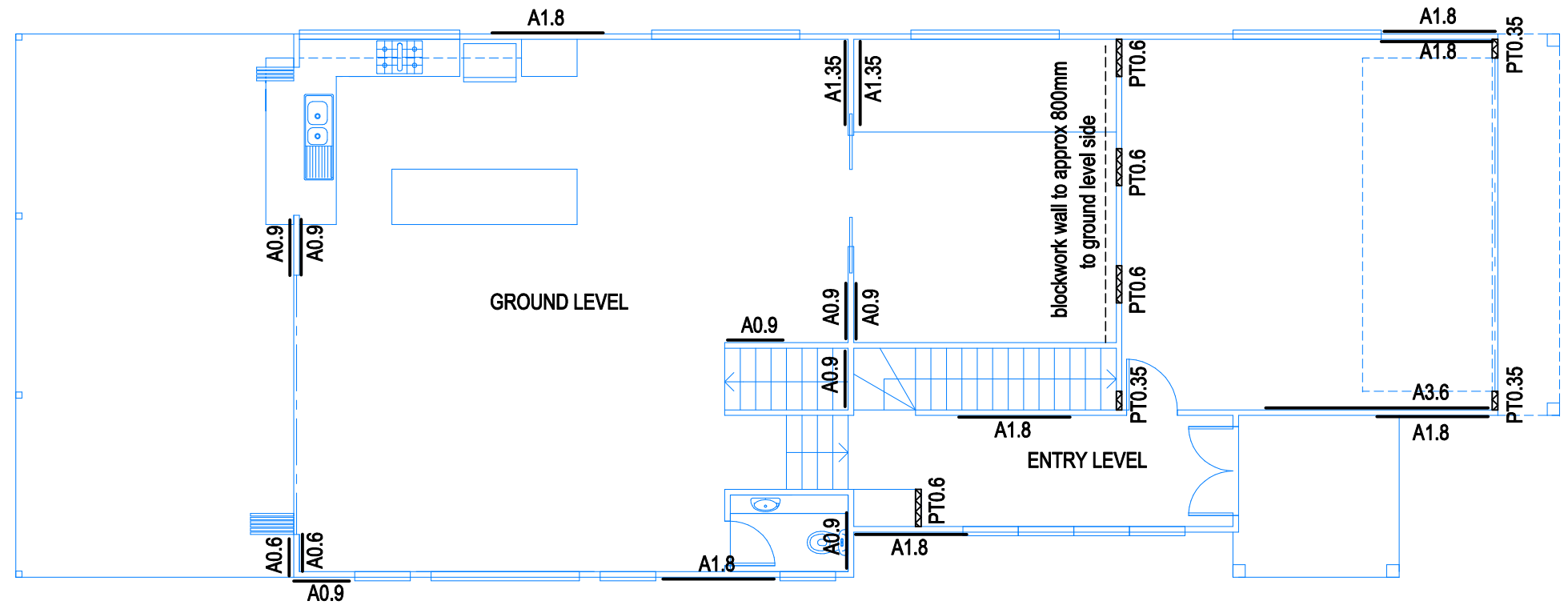

Entry Level

DIRECTION	AREA	PRESSURE	REQUIRED	ACHIEVED
↕	58.2m ²	1.4	81.5 kN	87.1 kN
↔	45.5m ²	1.4	65.95 kN	75.6 kN

PT= PT bracing system as per manufacturers specification

A= 6kN/m plywood bracing as per AS1684.2-2006 Table 8.18 'h'.