

WATER SAVINGS

WATER SAVINGS TARGET TO BE REACHED IN ACCORDANCE WITH PART 25 OF THE QDC

1. PROVIDE WATER TANK/S WITH A MINIMUM 5000L CAPACITY
2. TANKS TO RECEIVE RAINFALL FROM AT LEAST ONE HALF OF THE ROOF CATCHMENT AREA OR 100m², WHICHEVER IS THE LESSER.
3. RAINWATER TANKS ARE TO SUPPLY WATER FOR EXTERNAL USE AND INTERNAL USE TO TOILET CISTERNS AND WASHING MACHINE COLD WATER TAPS.
4. INTERNAL FIXTURES SUPPLIED FROM A RAINWATER TANK MUST HAVE CONTINUOUS SUPPLY OF WATER BY USING AN AUTOMATIC SWITCHING DEVICE OR A TRICKLE TOP UP SYSTEM

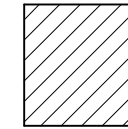
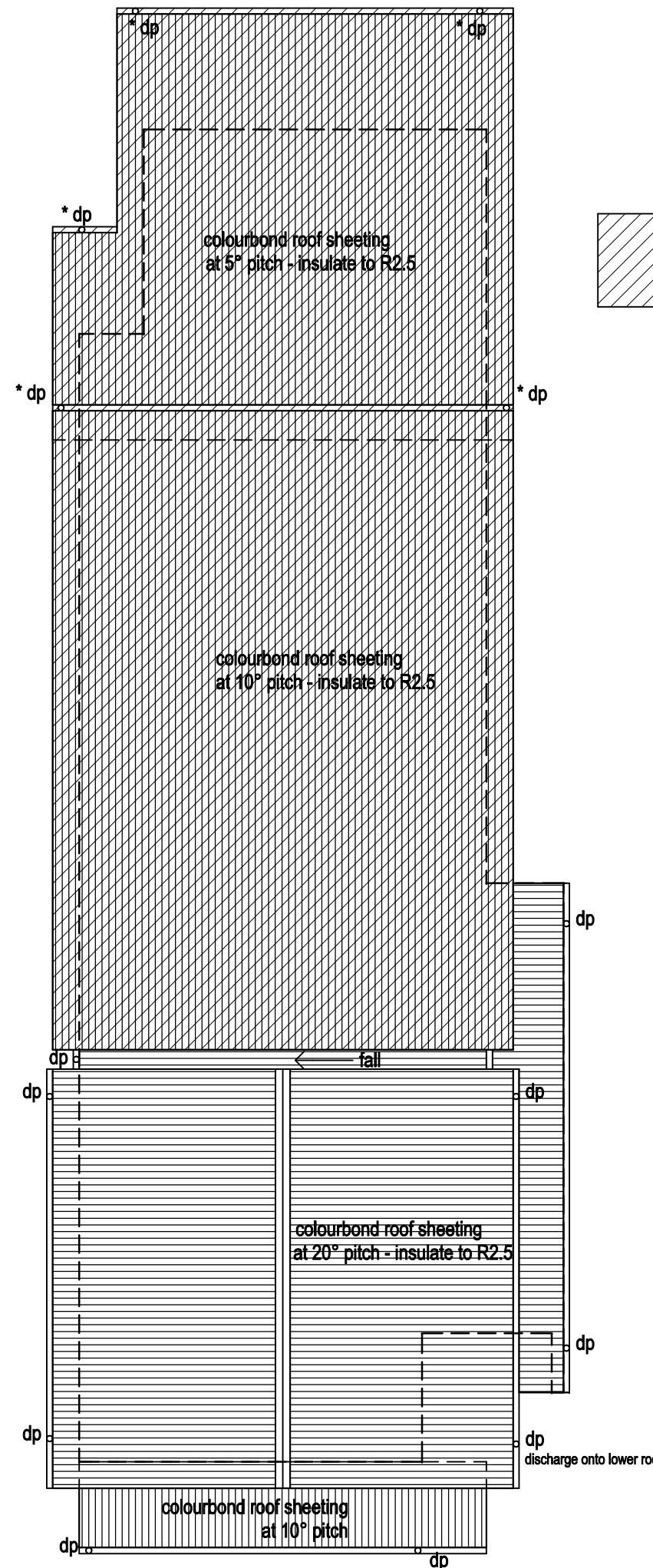

roof rainwater catchment area = 132.8m²

* dp = downpipes to water tanks to have first flush and leaf eaters