

GROUND FLOOR

PLYWOOD
 PLYWOOD SHALL BE NAILED TO FRAME
 USING 30/2.8mmØ FLATHEAD NAILS OR
 EQUIVALENT.
 HORIZONTAL BUTT JOINTS SHALL BE PERMITTED
 PROVIDED NAIL FIXED TO NOGGING AT 50mm
 CENTRES.

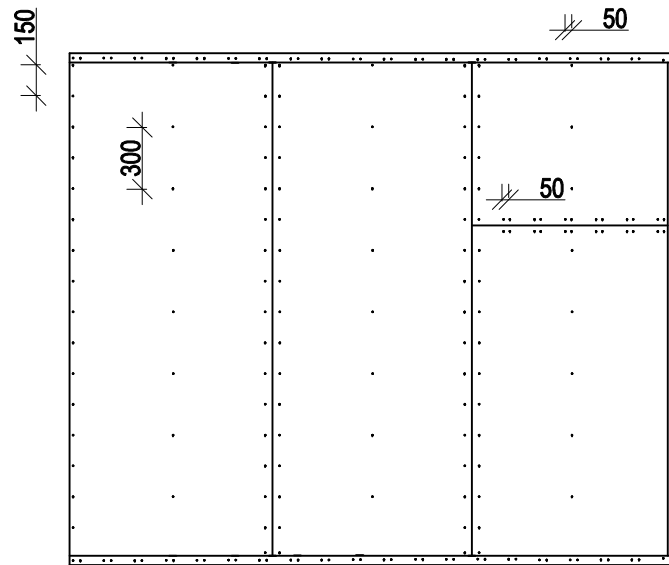

SHEETED PANEL SHALL BE
 CONNECTED TO SUB FLOOR

TYPE H METHOD 'B'

BRACING N2 GROUND FLOOR

DIRECTION	AREA	PRESSURE	REQUIRED	ACHIEVED
↕	38.9m ²	0.92	35.8 Kn	48.6 kN
↔	136.3m ²	0.81	110.4 kN	123.3 kN

A= 6kN/m plywood bracing as per AS1684.2-2006
 Table 8.18 'h'.

BRACING N2 FIRST FLOOR

DIRECTION	AREA	PRESSURE	REQUIRED	ACHIEVED
↕	16.9m ²	0.92	15.6 Kn	37.8 kN
↔	71.3m ²	0.70	49.9 kN	63.0 kN

FASTENER SPACING =50mm
 VERTICAL EDGES=150mm
 INTERMEDIATE STUDS=300mm

BRACING CAPACITY=6.0 kN/M

MINIMUM PLYWOOD THICKNESSES (mm)		
STRESS GRADE	STUD SPACING (mm)	
	450	600
F8	7	9
F11	6	7
F14	4	6
F27	4	4.5

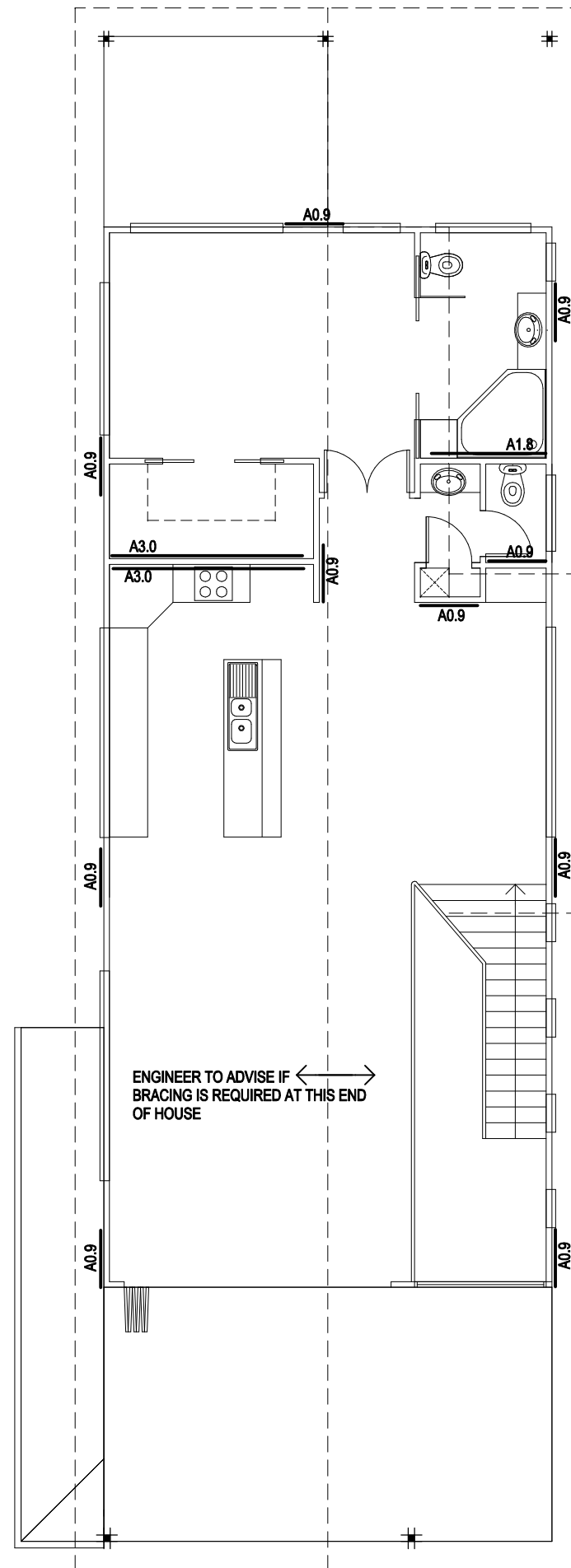

FIRST FLOOR